



February 15, 2021

TO: Parks and Recreation Advisory Committee

FROM: Ron Munds, General Manager

SUBJECT: Agenda Item 3 – 02/15/2022 Parks & Recreation Meeting
Review of the Updated Dog Park Concept Plan Comments and Project Update

President
Matthew D. Fourcroy

Vice President
Charles L. Cesena

Directors
Troy C. Gatchell
Marshall E. Ochylski
Christine M. Womack

General Manager
Ron Munds

District Accountant
Robert Stilts, CPA

Unit Chief
Eddy Moore

Battalion Chief
Paul Provence

Mailing Address:
P.O. Box 6064
Los Osos, CA 93412

Offices:
2122 9th Street, Suite 110
Los Osos, CA 93402

Phone: 805/528-9370
FAX: 805/528-9377

www.losososcsl.org

DESCRIPTION

At the last Parks & Recreation Advisory Committee (PRAC) the committee discussed the design elements of the concept plan. Based on the discussion, a revised concept plan was drafted. At this meeting, the committee will review the revised plan and begin the conversation other components such as fencing and other features needed.

RECOMMENDATION

Staff Recommendation:

1. Approve the updated Dog Park summary flyer for distribution
2. Provide staff with general direction on the next steps to be taken in regards to revised Dog Park Conceptual Plan, amenities to be included for further discussion and a continued community outreach strategy.

DISCUSSION

Background

At the last Parks & Recreation Advisory Committee (PRAC) on December 14th, the committee discussed the one-page flyer, the update to parking requirements, using natural surfaces as much as possible, the potential of a community garden, the County Master Plan and the Habitat Conservation Plan.

Since the December meeting, there has been continued interest in the Dog Park and additional public comments have been received. Suggestions include adding a community garden and pickleball courts to the plan. We will review and discuss the comments and determine how the committee would like to incorporate any of the suggestions into the concept plan. The comments received to date have been attached to this report.

Summary of Changes to the Conceptual Plan

The primary changes made to the original design are as follows:

- Enlarged the fenced area by 3,000 square feet
- Redesigned the parking based on feedback from County Planning and the committee
- Added “dog turf” in the entrance area
- Added concrete in the front plaza area to help with the native sand issues
- Eliminated the bathroom

- Decreased the decomposed granite (DG) area at the entrance and added DG pathways

Decision Points Moving Forward

It is important that the committee continue to discuss not only the overall design of the Dog Park but the specific component and amenities that are to be included in the final plan. These include fencing, surface material, entrance design, landscape and amenities such as benches, bathrooms and drinking fountains. All this will lead to developing a cost estimate which can be used to search for grant and other funding opportunities, and to develop a timeline to complete the project.

Items to Discuss:

- Surface – Pathways (already agreed with moving forward with primarily natural surface)
- Fencing
- Entrances
- Landscaping/Plants
- Water Availability
- Benches
- Waste Stations (poop bags and trash cans)
- Signage
- Other Amenities?

Staff is also seeking direction on how to best continue the public outreach to the community and to hone in more on the specific component and amenities that should be included in the final plan. This includes approval of the revised concept plan flyer (attached).

Public Comment Summary

To briefly summarize the comments (approximately 90) from 2019-2021 time period, most voiced support of the Dog Park Concept Plan. In these comments there were many comments/inquiries on the surface, size of the park, having drinking water available for the dogs, having a small training/agility area for individual dogs, benches for the dog owners, and the parking. Other comments of note were asking about finances, timeline, community garden, public input from neighbors, trees/shading, and sound.

The most recent round of comments received were generated by other interested parties and individuals reaching out through social media which has been very effective as well as through the February District E-News Online. Input by the committee and others regarding the best approach moving forward is important to continuing the momentum as the District proceeds.

Since the December meeting an additional 14 comments have been received. The following a summary of those comments:

- (6) suggesting Pickle Ball Courts be included
- (2) Maintenance Plan (Doggie bags/trash/trash collection)
- (2) Water supply
- (1) Connecting to the County pathway/park
- (1) Paved Pathway
- (2) Entrance into the Dog Park/gates
- (1) Hours park will be open/night lighting
- (1) Restrooms
- (1) Benches

In summary, staff will take the input received at the meeting and determine the next steps for the project and research and compile information in preparation for the next PRAC meeting tentatively scheduled April 19, 2022. Staff will also continue to solicit input from the community based on any suggestions received at the meeting.

Attachment

Public Comments

Dog Park Summary Flyer



APN 074-229-027

AREA OF DISTURBANCE: 66,295 SF

IMPERVIOUS AREA: 11,388 SF

DOG PARK AREA: 23,236 SF

LARGE BREED AREA: 16,857 SF

SMALL BREED AREA: 5,748 SF

CONCEPT TREES

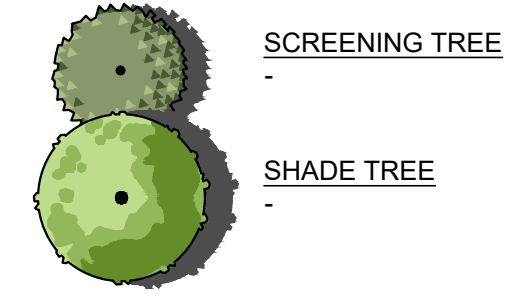

SITE DEVELOPMENT

SYMBOL	NOTES
	ORNAMENTAL SHRUBS -DRIP IRRIGATION & MULCH
	DROUGHT TOLERANT NATIVE REVEGETATION -DRIP IRRIGATION
	EROSION CONTROL HYDROSEED MIX
	CONCRETE PATH
	ASPHALT
	PARK SURFACE A
	PARK SURFACE B
	ARTIFICIAL DOG TURF

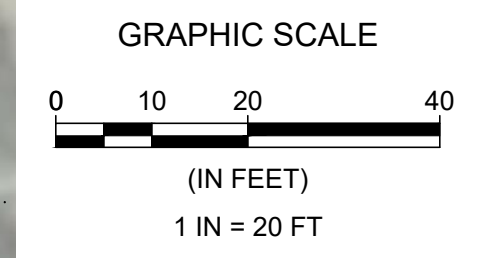
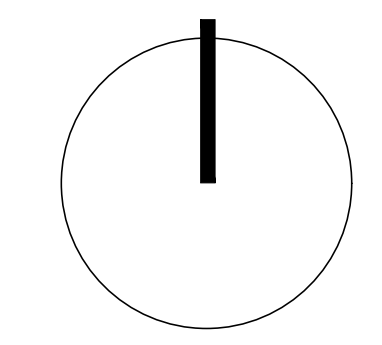

LOS OSOS DOG PARK - CONCEPT PLAN

January 17, 2022

Comments Received Relating to the Dog Park and the Dog Park Concept Plan as of 02/11/22 at 2PM

Comments:	<p>Hello -</p> <p>I just wanted to provide some feedback or thoughts on the proposed dog park plan.</p> <p>It would be great if the dog park was better connected to the rest of the park, and not separated by sand and bushes.</p> <p>Has there been consideration to putting a paved path around the dog park that was connected to the other paved path going around the grass area? this would provide a longer walking path and utilize the area around the dog park fence.</p> <p>Lastly, will the screening berm and trees be built in a way that is not conducive to a homeless encampment? As not to provide a hidden and protected area in the back that would entice moving in.</p> <p>Thank you for all you do, and for being willing to seek input on the new dog park.</p>
------------------	---

Comments:	<p>Is there just the one entrance by the parking area, or are there other walk-in entrances? If so, where are they? Is the present chain-link fence upslope from the church's retaining wall the boundary of the new park? Will the park be open 24/7 with night lighting, or only open during daylight hours? Will the park be locked during certain hours, or always accessible? Thank you.</p>
------------------	---

Comments:	<p>It is hard to tell from the concept drawing if the dog park includes restrooms. If not, I think it should.</p> <p>Also benches in both the large and small dog section are important.</p>
------------------	--

Comments:	<p>Many thanks to the Wallace Group for all the concept/design work</p> <p>Looks very good to me. I only wish I still had a doggo.</p> <p>What is the plan for maintenance? Is it self-serve/bring your doggie bag? Will there be any county maintenance? Garbage collection service?</p> <p>Thank you to the P & R working group.</p>
------------------	--

Comments:	I like the idea of a dog park but would also recommend putting in a couple of pickle ball courts. Perhaps the players can help fund this
Comments:	Is there a plan for a potable water supply so people can fill water dishes? I know this is a high level diagram but recommend a double gated system. "A dog trap" in between gates so dogs can't just run out if someone opens a singular gate into the different areas. That's how Chorro dog park works. Each area should have a doggie bag and trash receptacle system. Overall it looks good.
Comments:	We need a pickleball court here in our town! Driving to Morro Bay does not make economic sense or environmental sense by more driving back and forth!
Comments:	Hard to tell from the plan but there should be separate entrances for the large and small breeds to minimize problems. There should be a water area in both sections too.
Comments:	I just sent you an email regarding pickleball courts in LO. I saw there is a Parks & Rec meeting on February 15th. Can you add this to your agenda? Please let me know this would be a great asset to the community as a start to improve the extreme lack of diverse recreational options in LO. We have been in contact with ECOSLO regarding planting trees in Los Osos. They got a grant for 244 trees with 3 years of maintenance to plant anywhere in the County!! Thank you
Comments:	Hello, Less than a week ago I posted on Nextdoor in Los Osos inquiring about interest in pickleball. There have been over 100 favorable responses. Several people suggested that I contact the CSD regarding this as a way to improve the lack of diverse recreational activity options here. Please let me know how the CSD might be able to help. Thank you
Comments:	Add pickle ball courts to dog park addition.
Comments:	We'd love to see pickleball here in Los Osos!
Comments:	I want to express how much I hope the dog park and community garden can come to fruition and coexist to the benefit of our lovely

	community. One of the things I so enjoyed living here was the community garden with all its healthy benefits including social connections and support. As a multi dog owner I would love to see a dog park for our fur babies who also need a safe social environment. Please do consider and vote for these to important aspects of our community.
--	---

Comments:	Please, please convert some of the tennis courts into pickle ball courts!!
------------------	--

Comments previously presented at the 12/14/21 PRAC Meeting

Comments:	I don't support the community garden. I want the frisbe golf to remain there also pickle-ball courts instead of more tennis courts.
------------------	---

Comments:	The dog park is fine (we have two small granddogs who live half the year with us), but I hope that some space and water is also made available for a community garden. That is an equally important and probably more valuable long-term need for Los Osos, I believe. Do both, but don't leave out the garden!
------------------	---

Comments:	Great idea but we don't need all that parking, utilize street parking and keep a couple handicapped spots, but otherwise remove most of the parking and instead put something else in like bocce ball or pickle ball court
------------------	--

Comments:	I support continuing with the plan for a dog park. Even though I don't have a dog at this time, it would be utilized by many in our community and offers a positive impact to the children in Los Osos since dogs would not using our school fields for exercise. Although the Baywood community garden was lovely, I want to hear more about water conservation if this project moves forward with a garden. If combining the projects delays the dog park, please continue with only the dog park.
------------------	--

Comments:	As we know Los Osos has been below par on parks/population for a long time. I can't think of another community in SLO County that doesn't have a decent park. I'm not sure how much acreage is slated for this but a dog park, a few pickleball courts, a community garden and an area for kids to play- decent equipment which is lacking at the Community Park in Los Osos currently and a sports field. There is a
------------------	---

	<p>lot of acreage around this area so that is not the problem it's getting someone or a group to make it happen. Sounds like the State has some grant money for parks but of course the County has to apply or come forward to allow grant money to be used in this manner. Tree planting grant money has also been available through various agencies such as Calfire but again an application needs to be done and the County has to allow tree planting in locations in Los Osos within their jurisdiction for the grant money to be awarded. So far all the County says is "No" as other towns obtain grant money and do many improvements for their citizens. I am hopeful that we can do something if we all work together towards the same goal.</p>
--	---

Comments:	<p>A community garden would be s valuable asset in Los Osos.</p>
------------------	--

Comments:	<p>I'd love to see a community garden incorporated into the plans. Losing the Baywood community garden was a huge loss. That garden was where I decided I wanted to live in Los Osos indefinitely, where I got my inspiration of what to plant so I can grow food for my family and neighbors, and a beautiful place to enjoy. Having the community garden near the dog park is a perfect location for community members of all ages to have easy access to learn about growing plants, share tips and advice, and pick up free seedlings so everyone can start their own garden no matter their living situation or food insecurity. We have an incredible opportunity to incorporate a community garden in the plans and I hope my comments help describe how much this can positively impact our community. Thank you.</p>
------------------	---

Comments:	<p>I've been hoping for a dog park in Los Osos for many years. Since many walking areas in Los Osos are not allowing dogs due to California State laws it would be great to have a dog park for them to get exercise. Thank you for considering this and hopefully it will happen.</p>
------------------	--

Comments:	<p>I've been here 29 years. In those 29 years there has been lots of talk about a dog park, a few promises, but nothing accomplished. I'd like to see the dog park complete and, as others have mentioned in the past, perhaps in memory of Steve Best. Lets get this done! The Garden will be a nice addition to LO, one which should be done after the Dog Park. The canines have waited long enough. The gophers will have their turn later.</p>
------------------	---

Comments:	Will there be a walking path/track for people in the park? That would be really a nice addition to our town.
Comments:	As a dog owner who used to drive to Del Mar park a lot, I would rather go ahead with the dog park and then see what is available for a community garden as a separate project. I don't think they need to be next to each other.
Comments:	What is the anticipated cost for the project and long-term maintenance?
Comments:	Fabulous job to all working on this much needed project!
Comments:	I have no dog, and my cats aren't interested, but I would welcome by tax dollars going to a dog park.
Comments:	The garden plan can be simply an addendum to the dog park plan, not a complete re-write of it. No additional land involved. Plants don't fight, bark, run away, or poop. Organic/non chemical gardening can be required. The former garden was lush with gorgeous blooms and veggies. Lots to love and create a beautiful space. – I wonder if the Cal Poly landscape architecture undergrads could submit (free) design proposals. Good experience for them, perhaps a modest prize or plaque for the chosen design.
Comments:	I think it makes a lot of sense to have the dog park + the garden in the same area, as an expansion of the "community hub" with the park, community ctr, library, etc., and also the potential of sharing planning + building resources vs 2 completely separate projects. But I would hate to see the dog park waylaid or greatly delayed b/c of it. – I would be concerned a/b modifications that rely too heavily on street parking, taking into consideration the eventual library remodel/expansion, etc. Also isn't there a proposal for extensive housing in the area between Pine + Palisades (to which I am extremely opposed)?? How would that affect the potential use of that street.
Comments:	Los Osos Park Ideas: Please consider putting in Pickleball Court (perhaps next to the tennis courts other side of the fence). Dog Park. Also a Park Clean up day (needles have been found in our court).

Comments:	There are many issues to consider. A parking lot will only allow more homeless people to "park it" there. Moreover, who is going to close up the park at night? Or will it run all night? As some one who lives on Bush, I will MAKE SURE legally that my property values are not destroyed due to your "half-ass" plans.
------------------	---

Comments:	As someone who runs or walks through here almost daily, I don't like the massive addition of parking. There is more than enough street parking available. The front 5 spots seem more than adequate to provide handicap access and the rest of us can walk up from the street or our homes. It would also free up space for the community garden everyone seems to want, or to add the addition tennis court(s) or play areas as originally proposed. Personally I was hoping some of this land could be developed into bocce or pickle ball courts also. Overall it seems like a great start to a plan for the dog park, but the parking and driveway take up way too much valuable land.
------------------	--

Comments:	I would love to have a dog park nearby! I won't use the unfenced one in Laguna Lake Park due to safety concerns, so I must go to the dog park in Morro Bay, or the Cayucas dog beach. These are all far enough away that I can't take my dogs there as often as I'd like, due to time constraints. In the final design for the dog park, I would encourage the use of drought tolerate native pollinator plants, particularly those that would encourage the resurgence of the Monarch Butterfly, such as native milkweed. Thank you for considering my input.
------------------	--

Comments:	Los Osos is in desperate need of public space within the town, especially space that is dog friendly. The amount of people that end up using the fields at the schools in town as if they were normal public parks should be enough evidence that there is an undeserved need. I fully support this plan for a dog park. My only concern is the amount of space taken up by yet another parking lot. It seems absurd that it would be necessary to build more parking when there is an underutilized lot at the community center, an underutilized lot at the library, and plenty of street parking on Palisades avenue. A few handicapped spots to comply with state/county regulations should be sufficient.
------------------	--

Comments:	I support the dog park /community garden plan. Please make it happen ASAP. Thank you
------------------	--

Comments:	this is for parks and rec, what a great opportunity, the Otto Property at the end of First street is coming on the market, wouldn't it be great if the community brought the property for a Public PARK. what a great location, this would be a great place for community events. think about it.
------------------	---

Comments:	Yes, we need both a dog park and community garden!
------------------	--

Comments:	This plan looks like a great use of the space and would provide a safe dog park area and central community garden. Los Osos really needs more parks and resources as we grow get more businesses and become a more family oriented connected community. (Mom of three and dog mom of 1)
------------------	--

Comments:	I am in full support of a Los Osos community garden and dog park. Especially the dog park as the closest one is at El Chorro or you have to go up tomorrow bay to the dog beach which is not always something I prefer being older and it would be a great addition to our community services. Hopefully we can move out the overnight campers and reclaim Los Osos only library community park and our community center the red barn and hopefully a dog park and community garden where we have a true sense of community in the area designated for that thank you
------------------	---

Comments:	I fully support this idea!
------------------	----------------------------

Comments:	A dog park would be such a wonderful addition to our community!! I have lived in Los osos for over 12 years and have always longed for a dog park to help my large dog get some wiggles out. This needs to happen!
------------------	--

Comments:	Glad to see this happening. Please add a few benches inside and out of the fenced areas. It would also be nice to have pooper scoopers and trash cans.
------------------	--

Comments:	We definitely need a dog park. We need more tennis courts. They are full many times of the week / days and evenings with people waiting. We need a revision or clean up of the current tennis court lights. A community garden would be great.
------------------	--

Comments:	We would love to have a dog park and community garden here. I know lots of folks are hesitant because it's not perfect for everyone, but I think it's great. Dog owners currently either have to drive out of town or break the rules about dogs on campus at our schools. This is a NEED. Thank you!
Comments:	I am in favor of this plan as we have been waiting for this for years. That area is overgrown and not used today. The design of this is well thought out. There is other chatter about people trying to modify this plan to include a community garden. I think that would be a very bad idea. It would reduce the size of this park or eliminate the parking, both of which would not be appropriate for the needs. Also, a community garden serves only a couple dozen people where the dog park would be used by hundreds. Thank you for all your work.
Comments:	If it stops people from bringing their dogs from crapping on our kids' playground areas, might be a good idea. Los Osos needs more parks for kids! Outside the school playgrounds, which are sometimes locked, we only have ONE park in ALL of Los Osos for kids. Let's take care of our kids before our 2 legged friends.
Comments:	A dog park is sorely needed in Los Osos - and would be a major plus for community members and their pets. The present, considered area seems a perfect match for this venue., trusting we have no homeless encampment on the approaching street. When will work begin? Completed? Who will monitor / maintain the area? Will water be available for pets as well for planted areas?
Comments:	As a dog owner and resident of Los Osos for over 30 years I think a dog park is a long time coming. We NEED one. It would alleviate the LOMS issues and other places where people get upset if dogs are present. There is a very large percentage of dog owners in this town and I am certain it would be used round the clock. Please please please move forward. Regarding the community garden. Although a nice idea I do not think it is nearly as important as a dog park and I would not want the idea of combining the two to delay the dog park being built. Thanks
Comments:	I don't want this to end up looking like the skate park - separate from its environment. I think you need to increase the number of surrounding trees and maybe put in some gardens or even a community garden - we just lost one. More emphasis needs to be put on pedestrian and bicycle access and movability (if that's a word)

	within the park and little less emphasis on autos which seems at this point to take up almost half of the plan.
--	---

Comments:	I would support such a project.
------------------	---------------------------------

Comments:	I love the idea and the concept.!!!
------------------	-------------------------------------

Comments:	We need a dog park in our community . Although the community center is currently serving as de facto dog exercise area, citizens who use it are subject to a citation from Animal Control. We must do better for our community and our canine companions . Having to drive out of area to access legit off leash areas is a real hardship for those with limited time and/or the vehicle access to reach that destination. If we want to continue a sense of community and personal investment in our Los Osos area, a community garden: dog park sounds like a plan that is long overdue.
------------------	--

Comments:	I know we have to watch water, but I would rather have the grassy area inside the dog park and low water planting outside.
------------------	--

Comments:	Much needed!! Looks great! Love the dog paw surface
------------------	---

Comments:	I would love to see a much needed dog park go in Los Osos. It would make it cleaner and safer at our middle school if we had a dog park, because than dog owners would follow the rules and stop taking their dogs to Los Osos Middle School and Baywood Elementary! I loved being able to walk through Baywood Community Garden, it was lovely. The garden beds inspired me and my children to plant different things in our own garden. I think it is a great idea especially for those that don't have any space or access to garden as well.
------------------	--

Comments:	A local Dog Park is important! LO enjoys a large 4-legged population + needs to devote some resources to it, both to enhance quality of life, but also to lessen the impact on nearby open spaces, etc. I think it makes a lot of sense to have the dog park + a community garden in the same area, as an expansion of the "community hub" with the park, community ctr, library, etc, and also for the potential of possibly
------------------	---

	sharing planning + building resources vs 2 completely separate projects. ***BUT I would NOT WANT to see Dog Park plans waylaid, endangered or greatly delayed b/c of it. I strongly support plans for a local Dog Park + am open to pledging my future support, time, efforts, etc to its creation + maintenance.
--	---

Comments:	I am in support of a dog park. We already go to the community center to meet up with a small group in the evenings. However, unless it is natural grass (surface a and surface b) I would not bring my dogs there. That has been the main reason why I don't bring my dogs to Laguna, Chorro, etc. Hard and gravel surfaces, as much as they may be convenient for picking up poop, tear up their pads and are disgustingly unsanitary and do not drain. I have been in many dog parks (and have designed dog runs myself) where the smell is atrocious if not constantly maintained. Even turf collects urine, etc without being hosed regularly and Los Osos, as well as larger CA, has a water problem. I would not subject my dog to such conditions, otherwise.
------------------	--

Comments:	I am 100%in favor of a dog park and community garden at the proposed site. It's much needed and will free LOMS field of dog droppings! I hope there's a section planned for small dogs. – If this combination proposal will in any way slow things down or diminish the possibility of this being realized, then I support the Dog Park
------------------	---

Comments:	I would REALLY love a dog park in Los Osos!! Not because I have a dog but because I have young children who would love to kick a ball around after school. There are so few accessible green fields in Los Osos, and they are all taken over by dogs. It is not fun to kick a ball & then have your toddler get frightened by a charging dog. There are signs not to bring dogs, but people do it anyways because there is no where else and this is a major dog town! I love dogs, they just need their own space!!
------------------	--

Comments:	We need dog park! Morro Bay has 1 plus dog beach Cayucos has beach and park
------------------	---

Comments:	As a new resident and dog owner in Los Osos, this is something we are missing! Most of my neighbors have dogs and I see many residents walking their dogs. Many of us drive to neighboring towns to
------------------	---

	go to these specialized parks, so we are missing out on an opportunity to build community. Let's make this happen!!
--	---

Comments:	I applaud this plan to develop a new dog park! As the plan shows, there is clearly room and opportunity to create a new Community Garden alongside the dog park. I'm sure plenty of residents would volunteer to make this happen. The former Community Garden on 3rd and El Moro near the Pier was a huge success and many non-gardeners enjoyed its beauty and areas of repose. Being across from the library, it would also create lovely outdoor meeting space for book groups and other quiet gatherings. Please do include a new Community Garden in these plans!
------------------	---

Comments:	I would like to see a Community Garden in addition to a Dog Park in this location. With 1.52 acres, I think there would be enough room, if you were to only add handicapped parking to this area, and allow parking at the SBCC.
------------------	--

Comments:	I think a community garden area should be incorporated in the plan. I think some of the proposed parking could be eliminated to save money/space and the parking owned by the county at SBCC be used.
------------------	---

Comments:	How far have the dog park plans advanced? Thanks.
------------------	---

Comments:	Please make this happen! How can we help?
------------------	---

Comments:	Hello! Thanks for working on the future dog park, but I'm more interested in helping to create a Community Garden. It is not clear where the garden would go, as the dog park is bordered by tennis courts, a parking lot and a nearby church. Could you please enlarge the map and indicate possible Community Garden sites? Thanks very much.
------------------	---

Comments:	Can't wait to see more info on the dog park! I hope to see the park in person sometime soon! My dog, Finn, and I would love to see water fountains at dog height at the park!!
------------------	--

Comments:	I'm concerned with the added noise (Barking Dogs) we already have loud noise from the community center from time to time and on weekends when we are trying to enjoy our yards. Also the less
------------------	---

fortunate/Homeless population already hide along the homeowners back fence line and with the added berms and screening I am concerned it may become worse

Comments: Hello, I Love this idea and am happy share my comments. My first initial impression is that there should be Less Parking Lot and More creatively designed Park space. There is already the park parking next door and street parking, so simple minimal frontage parking would work fine if Any. Plan to use this space to it's fullest potential! ~I would like to see at least 3 concept plans and narrow it down from there with community participation & voting, not just one plan to say Yes or No on. ~The more Trees the Better, the Less Impermeable surfaces the better. ~Incorporate walk in Entrance paths form several sides of the park. ~Create a dog/owner friendly run track for owners and dog to both exercise on, but designed with space for a faster level of travel (running/walking with dogs on a meandering loop). As a dog owner I often want to go run a track with my dog but can't ~ How wonderful it would be to do get a good walk/run in, and then let the dogs play in a safe gated zone after, or before. ~To avoid dog pit fighting chaos, I suggest creating separate gated areas, one for wild dog frenzy ball/Frisbee throwing, and other gated zone for those who simple want to sit more quietly with dog meeting other dogs with out the added hype. I don't know how important small dog vs. large dog is. ... Maybe have the small dog area and large dog area and a 3rd ball/Frisbee throwing area for those confident their dogs wont eat the small dogs? ~Use donated and recycled materials for fencing and walk ways. I like wood pole style fencing and if a running track/meandering path for owners is incorporated, I would like it made with field track material. Great Idea and Great Start!

Comments: A dog park in a town with minimal park space should not be so large nor should it be so centrally located. That area should be used as park space for children and families. The current children's play area is much too small with not enough play equipment. Put some of the dog park money into expanding that! The Cayucos dog park is much smaller and I have never seen more than a few dogs there. Either decrease the size or relocate it entirely to some available CSD property, such as 7th and Farrell. It is large enough for a dog park and the currently planned walking path.

Comments: Seriously? There's already a "dog park" across the street...Tax money was spent on that. Now its occupied by a homeless camp and you want to spend my tax dollars on another one? FAIL.

Comments:	Great! Been wanting a dog park for a long time.
Comments:	Joyfully anticipating a real Dog Park in Los Osos! Please have plenty of benches and trees. You've thought of drinking water sources, of course. Glad to see there are two double gates. Looking forward!
Comments:	This is an exceptional idea and plan and; one that is long overdue. My only input is this: this park should bear the name of Ann Calhoun. Ann lobbied endlessly for this park and it's exciting to see it moving along to this stage. I agreed with Ann on not one thing concerning the building of our sewer, but I still miss her witty insights and unique perspectives on life in Los Osos. What a fitting tribute this would be to her.
Comments:	Is the park going to have a liner to prevent urine from getting into the water table?
Comments:	I strongly support the plan. A dog park is very much needed in Los Osos. The surface material should be less muddy than the Del Mar park and less messy than El Chorro park. Is artificial turf a possibility?
Comments:	First, a big THANK YOU to all involved in moving forward a much needed Dog Park in our community. Big Picture Question: Why does it have such a large footprint? If we are to keep in step with the Vision found in the draft LO Community Plan, then walking and biking (e.g. non-motorized modes of transportation) are to be encouraged in our land use planning in order to achieve a more Livable Community atmosphere for our town's people. I submit these items for the Committee's consideration: 1. From the Park's Concept Plan map, there are 20 onsite parking spaces, including one ADA parking site. 2. The number of parking spaces suggests this Dog Park was designed as the "be-all and end-all" for dog parks in the South Bay. 3. Is this Dog Park intended to serve the entire LO/BP Community, or are others being planned that are more within walking distance? (Walking distance is considered by transit planners to be no more than a quarter mile to a bus stop). 4. Rather than having one big dog park that is car-oriented, what are the long term plans for a series of walkable dog parks strategically located throughout the Los Osos/Baywood Park community? 5. Having a greater number of smaller dog parks located throughout our community (on either existing county land or donated lands) would better meet the Vision of

	the LO Community Plan. Thanks for this opportunity to provide my input to the Dog Park Concept Plan.
--	--

Comments:	Hello and thank you for considering this project. I frequent the existing park located between the tennis courts and the community center and find it very nice and attractive. There are a number of regulars who meet to socialize and exercise their pets. In my experience, everyone is friendly and the pets well behaved. The pet owners are responsible and pick up dog droppings, etc. My suggestions include: Keep it simple. Don't overdo the landscaping. Laguna Lake's park has mostly dead trees and shrubs now. Waste bag dispensers are helpful. A water spigot would be nice. Possibly a weed abatement fence and wood shaving ground cover to minimize fox-tails. That's about it from me. Thanks again for your efforts!
------------------	--

Comments:	This has been in the works for so many years. Please, let's finally make this happen.
------------------	---

Comments:	A dog park is critical to the safety of humans and dogs in Los Osos. Having to avoid cars on non-existent sidewalks has been a challenge for me and my husband. To have a fenced in area for my high energy active dog will be amazing; not to mention the community building it will create by neighbors meeting one another. Thanks to all who are working so diligently on this project!
------------------	---

Comments:	Seems small. Thought it was going to be on the corner of LOVR and Pine, where all the non livable houses are. Since people go to the park to have their dogs run and go to the middle school to have them run, this seems inadequate.
------------------	---

Comments:	Add more shade trees. Add a shade/wind shelter where owners can sit and talk with other owners while the dogs play and explore. Make it a robust shelter, especially to shade/shelter from late afternoon/evening sun & sandy wind. Provide a watering point - but I don't know how you could secure it from misuse. Thanks
------------------	---

Comments:	I'm a local dog owner and would like to keep up with the progress towards the dog park. The concept plan looks good. I agree with some of the comments such as including picnic tables and benches. Do we really need that many parking spaces? It seems there is plenty of street parking available. Thank you
------------------	---

Comments:	I was on the board for the development of both the Paso and the Templeton Dog parks . One of the most important things we had to do was fund raising and PR work. I haven't heard how this park is going to be funded? Also, is the county imposing regulations?
Comments:	Hi! Am I correct in seeing that the dogs' actual play area is something other than grass? We take our dog to Del Mar dog park and I can't imagine that dogs would like something called "park surface" rather than a soft grassy area. Thanks for explaining the reasoning you have for this type of surface.
Comments:	I hope you plan to separate small from large dogs. I believe all dog parks in SLO County have separate play areas--for good reason.
Comments:	I'd like the dog park to have grass and shade trees with plenty of benches for dog owners. I'd also like a bathing pool for the dogs with a large water fountain that filters recycled water. Let's do it right the first time! No wood chips!
Comments:	I am in strong support of the Los Osos Dog Park. I believe the dog park is long overdue for our small community. I believe this is great location for our dog park. It is already adjacent to an existing park, across the street from the library and just down from our community center.
Comments:	A dog park is so needed here. And I appreciate all efforts to build one. And I'll use it. But, if I'm being honest, the planned park is too small by at least half. (Why not just designate that large area behind the library as an off leash area?) A water spigot would be good to fill water bowls. A few more trees. Benches for the two legged. A giant log for the dogs to climb and pee on. Not sure what is planned for the ground. Small bark chips are okay but rough cut chips like at the dog park out by Cuesta are horrible. TBH, I don't go there largely due to the splinter giving chips. It's also tough to pick up poop from. Better gravel, sand or just the bare ground. Lawn is the cleanest and best but probably impractical. Shovels, rakes, poop scoopers and bags encourage people to keep a dog park clean. Clearly marked signs with rules and regs. A volunteer board to organize clean up days etc. is a good idea even though it always gets ugly with politics. Lol. Thanks!

Comments:	I am a current resident of Los Osos, and have no dog. Yet I am fully in support of bringing a dog park to Los Osos. Without it, dog owners have few in-town choices and thus sometimes resort to bringing them to areas where they are technically not allowed - parks, schools - where they allow them off leash. Because those are the same areas where children are playing, kids' activities are impacted. Kids hesitate to throw a baseball for fear of a dog chasing after them. Kids hesitate to run around the field, for fear of being chased. Kids' guardians are frustrated at having to clean dog poop of a child's shoe, or comfort a child who is already afraid of dogs and is now crying because they got chased by one. The community of Los Osos needs a dog park that allows dogs a chance to run and be free in a dedicated space.
Comments:	This is great news. Please be sure water is available & consider bark where muddy areas drain.
Comments:	Is there enough space to fence off a separate space (a rectangle) that a single dog could inhabit to play fetch with its human? If you put a 10 minute time limit on its use I think the humans could work it out so that dogs could get their exercise.
Comments:	Great idea. Would take the wear and tear off other places that are used for sports and kids events and decrease emissions to drive to Morro Bay area or SLO area for the same purpose. Next let's build some soccer fields!
Comments:	Sight blocking material should be installed on the fence between the large dog and small dog play areas. Small dog surface should be primarily grass. If wood chips are to be used in the large dog area they should be SMALL, not large shreds or chunks or sticks. A few general suggestions.... Benches should be placed in both areas. A shed is needed for storage of materials (Mutt Mitts, hand sanitizers, yard maintenance equipment etc.). A small kiosk or the like is useful for posting park information, notices, donation envelopes, incident forms etc. Donation boxes or similar should be installed in both large and small play areas. Will the Parks and Rec Committee Meeting be open to the public ?
Comments:	Yay ! Osos really needs this. The only comment (questions) we have is about what kind of surface materials are being considered? El Chorro seems to be having issues with a poisonous mold/mushroom which may become a problem in the even wetter environment of los osos.. We like bark but many times it is NOT really bark but wood

	chips which can contain anything. Is there any way we can contribute (\$\$)?
--	--

Comments:	I support
------------------	-----------

Comments:	Please do not use wood chips for ground cover like Chorro dog part it's awful and very hard on the dogs paws.
------------------	---

Comments:	Looks wonderful. Just two comments. Please don't use chips/wood chips, at least in small dog area. My 12 pound dog can't walk in chips much less run - he actually trips over them. Grass is best. Del Mar dog park is great example. Second comment - if there is a way to curve the interior fence by the gate nearest main parking lot it will help keep incoming dogs from being mobbed by dogs already inside. Entry is most dangerous moment for the dog as he is outnumbered and there is lots of excitement. Fights often occur at the moment of entry as ALL the dogs check out the new guy - and it can be overwhelming and result in a fight if the new guy feels cornered. THANK YOU for all the work on this project and for being open to public input!
------------------	---

Comments:	Are there any benches within the grounds for dog owners to sit on? Fixed hydrating fountain for the dogs? Potty bag dispensers?
------------------	---

Comments:	Build it and we will come!
------------------	----------------------------

Comments:	Looks great!
------------------	--------------

Comments:	very exciting. my only comment is that the bark surface at el chorro is awful for the dogs- they get splinters in their mouth when they play fetch! the best dog park i've ever seen is "dogs run free" in Condon park, in Grass Valley. https://www.facebook.com/DogsRunFreeGV/
------------------	--

Comments:	Add an agility course!
------------------	------------------------

Comments:	I like this design. How tall will the fences be? Will there be anyone who cleans it up. People can be very bad at cleaning up after their dog. The separation between large and small dogs is really important. I've lived in Los Osos 34 years and have heard talk of this all that time. It would be wonderful to have a dog park.
------------------	--

Comments:	I walk my pup a couple of times every day. She has 8-9 that she walks with. They are all friendly and social. We always have to try to find places where they can be kids. We say almost daily what a joy a dog park would be. I know I be happy to volunteer to help maintain the park. I love the Chorro dog park but it is hard to get all our pups together. YES PLEASE.
------------------	--

Comments:	This idea probably doesn't belong here.. but, as someone who works with shelter animals and sees a lot of reactivity and aggression towards other dogs. It would be nice to make a field or grass area for dogs who don't get along with other dogs and need to get out some exercise with their owner. something they can rent for 30 minutes? And make some cash off of it. A lot of people in the area, don't have yards or don't have big enough yards to let their dog run around. I've always wanted to do something like this for the community because I know there's plenty of people who would use such a thing. Just maybe something to think about.
------------------	---

Comments:	Hopefully there can be water stations around the yard for the dogs! Also it would be great to have benches and or picnic tables for the humans to use. We can't wait to use the dog park! Thanks for your hard work!
------------------	--

Comments:	What an excellent concept! As local dog owners and residents for over 40 years, we hope this happens! The El Chorro Dog Park is nice, but a closer park would be so wonderful! What a great opportunity to socialize our dogs, and provide them a great place to play! Can't wait...Let's do it!
------------------	--

Comments:	We quit utilizing El Chorro Dog Park due to excessive dust created by active dogs. Our concern was potential transmission of Valley Fever spores in that horrendous dust. We are aware of dogs in Los Osos who frequented El Chorro Dog Park who contracted Valley Fever and later died. Wood chips are not the answer.
------------------	---

Comments:	Excellent Work!
------------------	-----------------

Comments:	It's a lovely plan. Is there a cost estimate to build? What kind of timing?
------------------	---

Comments:	Thank you for your efforts. Here are my initial questions: 1. How does this compare size-wise to other dog parks in the County? 2. Is there a
------------------	---

	sufficient visual break between the small and large dog areas? 3. It would be wonderful if the park could be designed to have a training area as a permanent or easily convertible component. Thanks again.
--	---

Comments:	I love it! I love that there is more parking as well, although I'm wondering how we plan to fund that. Thanks to the Wallace Group.
------------------	---

Comments:	Do we bring our doggie to the meeting? Looks like a good idea for the community. Not much space for a large dog.
------------------	--

Comments:	Please make sure those that live on that side of Bush drive, like myself, have greater input on issues such as noise, increased smells and the placing of trees to block views.
------------------	---

Comments:	The parking seems excessive because there are also between 8-10 parking options on Palisades, easily within walking distance for most dog owners. Realistic review of how many parking spots could be needed needs to be considered because it takes away space for the exercise area. The Skate Park provided zero extra parking spots when approved. Also ADA handicaps parking should be increased to at least 5 because many users in need of the opportunity to exercise and socialize their dogs are seniors or cannot walk easily. The plan is well-thought out otherwise. The restroom could use composting toilet technology, if we want to get innovative. Drinking water stations should be considered, as well as benches. Memorial bench options could cover the cost. Also please consider Memorial tree planting as a way to get more shade trees planted.
------------------	---

Comments:	The ground covering should be grass real or artificial for the dogs to run and play. Other ground coverings are not practical, dirt becomes muddy when it rains and stays that way for days till it dries out or becomes dusty during warm climate, wood chips are not comfortable for the dogs paws. I have had my dog play in parks with grass, wood chips or dirt and the grass covering has been the best for dogs to play and roll around on.
------------------	--

Comments:	Moreover, I see that there will be parking in the new proposed dog park. Will the county then start putting homeless people there along with the County library? If so, please expect lawsuits to the county and to individuals on the board who let this idea to go through. I'm am not kidding.
------------------	---

